

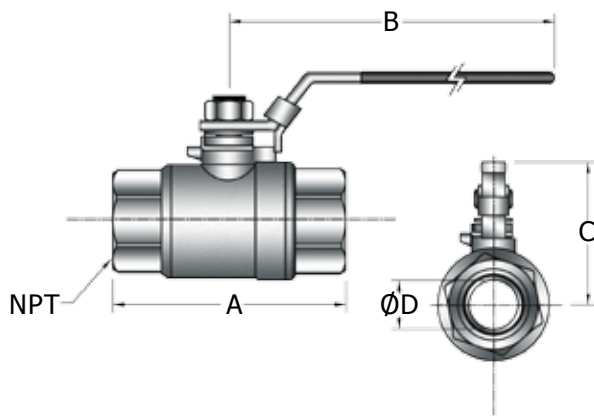

## SGF SERIES BALL VALVE

### Features:

- 316 Stainless Steel (CF8M)
- Full Port 2-Piece Ball Valve
- 29" Hg-1000psi WOG
- Blow Out Proof Stem
- Latch Lock Handle Standard
- RPTFE Seats and PTFE Seals
- Temperature -20°F to 400°F



### Dimensions

PART #	NPT	A	B	C	ØD	Cv	Wt. Lbs.
SGF-2	1/4"	2.00	3.94	2.30	0.46	6	0.50
SGF-3	3/8"	2.00	3.94	2.30	0.49	6	0.50
SGF-4	1/2"	2.28	3.94	2.30	0.59	18	0.70
SGF-6	3/4"	2.58	4.92	2.50	0.79	34	1.00
SGF-8	1"	3.10	5.87	3.07	0.98	49	1.70
SGF-10	1-1/4"	3.54	5.87	3.27	1.26	103	2.50
SGF-12	1-1/2"	4.13	7.48	4.02	1.50	266	3.90
SGF-16	2"	4.88	7.48	4.25	1.97	307	5.90
SGF-20	2-1/2"	5.75	9.84	5.43	2.48	C/F	12.40
SGF-24	3"	6.46	9.84	5.75	2.99	C/F	16.50
SGF-32	4"	9.45	11.81	6.89	3.94	C/F	30.00

### Bill of Materials

PART	Material
Body	ASTM A351-CF8M
End Cap	
Ball	
Stem	
Gland Nut	
Spring Washer	AISI 304
Lever	
Lever Nut	
Body Seal	PTFE
Packing	
Thrust Washer	
Ball Seat	RPTFE
Grip	PVC

