



HIF Series Hydraulic IN-LINE Filters

Features:

HIF Series:

- Clear Anodized Aluminum Filter
- 25 Micron Sintered Bronze Element
- 3000 PSIG (Hydraulic only) Max. Working Pressure
- Buna-N Seals 35°F to 200°F

Options:

Viton Seals, Suffix "V" 35°F to 400°F
 Micron Size, Suffix "10", "40", "90"
 (Example HIF-290), (Kit Example EK2-90)

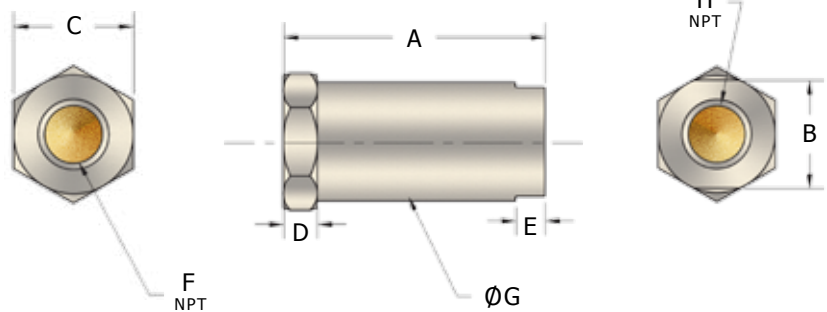

Dimensions:

Part	A	B	C	D	E	F NPT	ØG	H NPT	spring Kit	element Kit	Body	Element
HIF-2	3.30	1.38	1.50	0.43	0.37	1/4"	1.50	1/4"	SK2	EK2	2011-T3 Aluminum	25 Micron Sintered Bronze
HIF-2V	3.30	1.38	1.50	0.43	0.37	1/4"	1.50	1/4"	SK2	EK2V		
HIF-3	3.30	1.38	1.50	0.43	0.37	3/8"	1.50	3/8"	SK2	EK2		
HIF-3V	3.30	1.38	1.50	0.43	0.37	3/8"	1.50	3/8"	SK2	EK2V		
HIF-4	4.92	1.38	1.50	0.45	0.37	1/2"	1.50	1/2"	SK4	EK4		
HIF-4V	4.92	1.38	1.50	0.45	0.37	1/2"	1.50	1/2"	SK4	EK4V		
HIF-6	4.92	1.38	1.50	0.45	0.37	3/4"	1.50	3/4"	SK4	EK4		
HIF-6V	4.92	1.38	1.50	0.45	0.37	3/4"	1.50	3/4"	SK4	EK4V		

Part	A	B	C	D	E	F SAE	ØG	H SAE	spring Kit	element Kit	Body	Element
HIF-S6	3.30	1.38	1.50	0.43	0.37	9/16"	1.50	9/16"	SK2	EK2	2011-T3 Aluminum	25 Micron Sintered Bronze
HIF-S6V	3.30	1.38	1.50	0.43	0.37	9/16"	1.50	9/16"	SK2	EK2V		
HIF-S8	3.30	1.38	1.50	0.43	0.37	1/2"	1.50	1/2"	SK2	EK2		
HIF-S8V	3.30	1.38	1.50	0.43	0.37	1/2"	1.50	1/2"	SK2	EK2V		

