

Universal
Components
Inc.

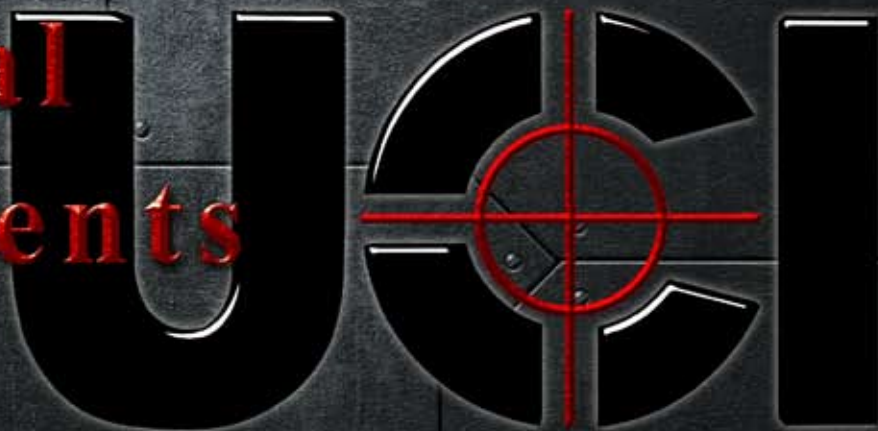

Butterfly
Valves



Lug and Wafer Butterfly Valves



MSS SP-67 Compliant

- ### Materials
- ANSI 125 & ANSI 150 Class
 - ISO 5211 Mounting Pad (standard)
 - Epoxy Coated Cast Iron Body
 - EPDM Resilient Seat (standard)
 - AP1609 Face to Face Flange
 - Temperature -30°F to 250°F
 - 10 Position Handle Standard (up to 12")

How to Order

SSB = Stainless Steel Body CF8M
B = Epoxy Coated Ductile Iron (Lug)
B = Epoxy Coated Cast Iron (Wafer)
S = Sanitary Tri-Clamp

L = Lug
W = Wafer
T = Tri-Clamp

None = Bare Stem
H = 10 Position Handle
G = Gear Operator

B N E L - 10 H

N = Nylon Coated Ductile Iron
S = Stainless Steel CF8M

E = EPDM*
B = Buna®
V = Viton®
T = Teflon®
S = Silicone (sanitary only)

1.5 = 1-1/2"
2 = 2"
2.5 = 2-1/2"
3 = 3"
4 = 4"
5 = 5"
6 = 6"
8 = 8"
10 = 10"
12 = 12"

* Food Grade on Sanitary Only

Materials

No.	Part	Material
1	Lug	Epoxy Coated Ductile Iron
	Wafer	Epoxy Coated Cast Iron
2	Seat	EPDM (-30° to 250°F)
3	Nylon Coated Disc	Ductile Iron + Nylon 11
	Stainless Steel Disc	CF8M
4	Lower Shaft	416 Stainless Steel
5	Upper Shaft	416 Stainless Steel
6	Location Pin	Carbon Steel
7	Bushing	PTFE
8	O-Ring	EPDM

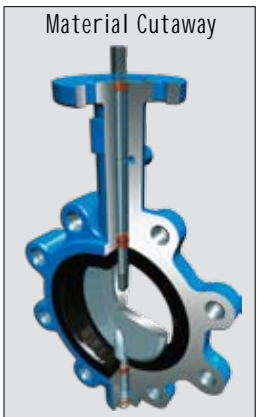



Lug and Wafer Butterfly Valves

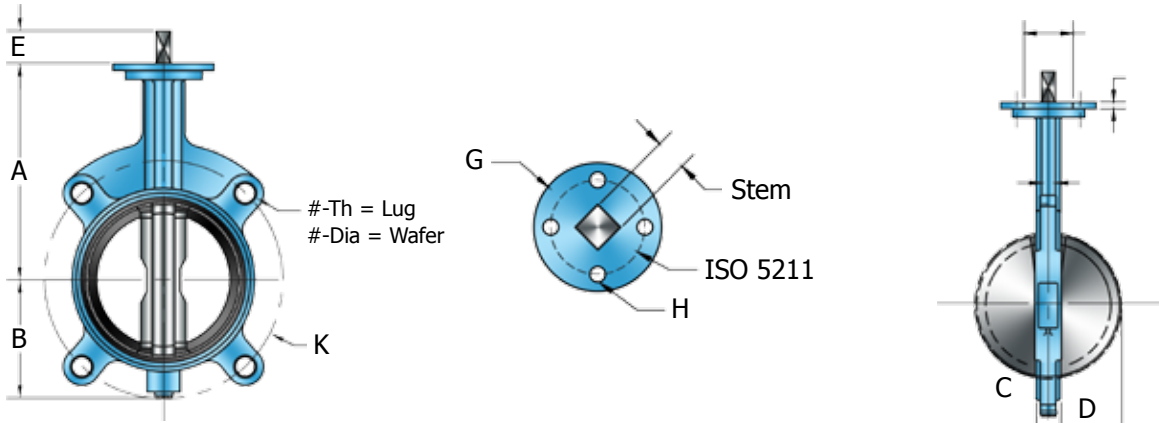

Dimensions

Size	ISO 5211	Stem	A	B	C	D	E	Upper Flange			Lug #-Dia Lbs	Wafer #-Th Lbs	Seat Torque		Cv (gpm@1psi)			
								G	H	K			100 Psi	200 Psi	50% OP	100% OP		
1-1/2"	F05	9mm	5.71	2.97	10.63	0.84	0.47	3.03	4-0.28	4.74	4-0.75	5.0	4-5/8"-11	7.1	111	133	35	108
2"	F05	9mm	6.34	3.15	10.63	1.04	0.47	3.03	4-0.28	4.74	4-0.75	5.5	4-5/8"-11	8.4	126	146	45	135
2-1/2"	F05	9mm	6.89	3.50	10.63	1.27	0.47	3.03	4-0.28	5.49	4-0.75	7.1	4-5/8"-11	9.3	134	167	65	220
3"	F05	9mm	7.13	3.74	10.63	1.55	0.47	3.03	4-0.28	6.00	4-0.75	8.4	4-5/8"-11	10.4	205	223	70	300
4"	F07	11mm	7.87	4.49	10.63	2.05	0.63	3.54	4-0.35	7.50	4-0.75	10.8	8-5/8"-11	19.8	339	386	140	605
5"	F07	14mm	8.34	5.00	10.63	2.43	0.75	3.54	4-0.35	8.50	4-0.87	15.4	8-3/4"-10	24.0	523	602	235	1010
6"	F07	14mm	8.90	5.47	10.63	3.07	0.75	3.54	4-0.35	9.50	4-0.87	17.2	8-3/4"-10	31.3	677	996	360	1620
8"	F10	17mm	10.24	6.89	12.01	3.99	0.75	4.92	4-0.47	11.75	4-0.87	29.1	8-3/4"-10	40.1	1205	1864	715	3205
10"	F10	22mm	11.50	7.99	13.27	4.93	0.95	4.92	4-0.47	14.25	4-1.00	42.2	12-7/8"-9	59.1	1890	3140	1225	5305
12"	F10	22mm	13.27	9.53	15.04	5.94	0.95	5.51	4-0.47	17.00	4-1.00	71.5	12-7/8"-9	88.2	2808	4767	1900	8250

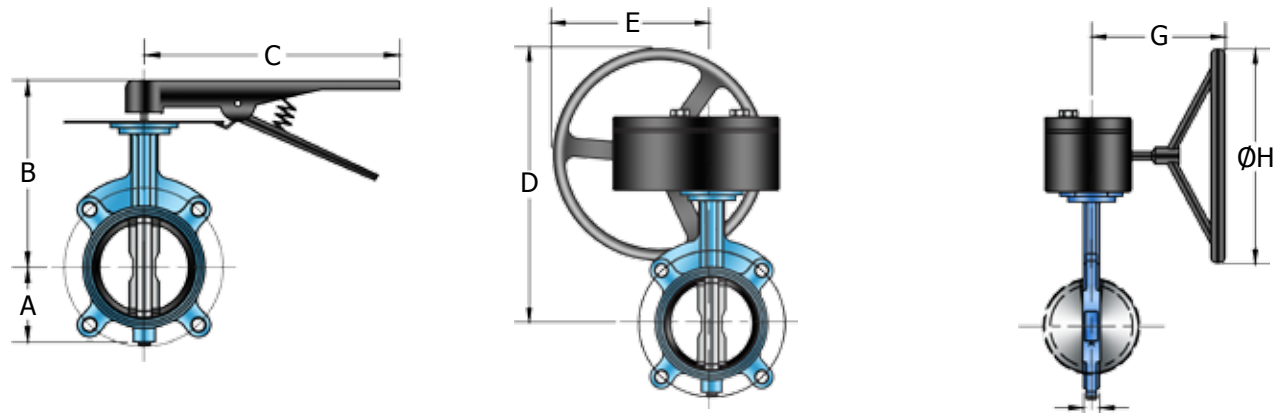

Dimensions with Operator

Size	A	B	C	D	E	G	Weight w/operator				ØH	Cv (gpm@1psi)	
							Wafer		Lug			50% OP	100% OP
							Lever	Gear	Lever	Gear			
1-1/2"	2.97	7.24	10.63	10.15	4.75	6.00	6.8	16.3	9.6	19.1	5.91	35	108
2"	3.14	7.60	10.63	10.78	4.75	6.00	7.5	17.0	10.4	19.9	5.91	45	135
2-1/2"	3.50	8.15	10.63	11.33	4.75	6.00	9.1	18.6	11.3	20.8	5.91	65	220
3"	3.74	8.38	10.63	11.57	4.75	6.00	10.4	19.9	12.4	21.9	5.91	70	300
4"	4.48	9.13	10.63	12.31	4.75	6.00	12.8	22.3	21.8	31.3	5.91	140	605
5"	4.99	9.60	10.63	12.78	4.75	6.00	17.4	26.9	26.0	35.5	5.91	235	1010
6"	5.47	10.16	10.63	13.34	4.75	6.00	19.2	28.7	33.3	42.8	5.91	360	1620
8"	6.88	12.01	14.17	17.84	8.35	9.84	33.4	57.8	44.4	68.8	11.81	715	3205
10"	7.99	13.27	19.68	19.04	8.35	9.84	48.1	70.9	64.9	87.8	11.81	1225	5305
12"	9.52	15.04	19.68	20.81	9.06	9.84	77.3	104.6	94.0	121.3	11.81	1900	8250



Sanitary Tri-Clamp Butterfly Valve



Complies with FDA, USDA and 3A

Materials

- Stainless Steel ASTM 316L Grade
- Surface Finish Meets 3-A, FDA & USDA Standards.
- 316L Mirror Finish Disc Provides an Even Flow Preventing Obstructions and Restrictions.
- EPDM Seats (standard)
- EPDM Resilient Seat (standard)
- FDA Approved Silicone, Viton® and White Viton® Seals are Available.
- Pressure 110psi@200°F
- 13-Position, 304SS, Spring Loaded Lever Lock Handle 1/2" to 6"

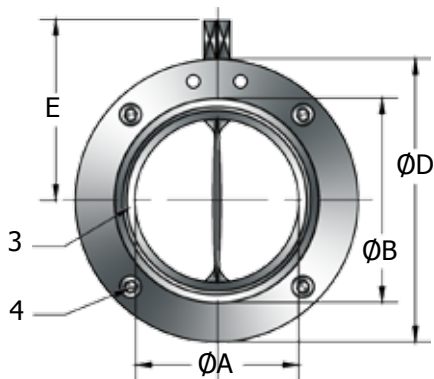
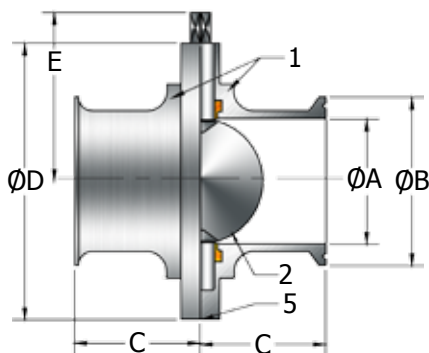

Dimensions

Tri-Clamp (Standard)						
Size	A	B	C	D	E	Torque in/Lbs
1/2"	0.37	1.00	1.75	3.10	2.16	130
3/4"	0.63	1.00	1.75	3.10	2.16	130
1"	0.87	3.00	1.75	3.11	2.40	190
1-1/2"	1.37	1.99	1.75	3.35	2.53	215
2"	1.87	2.52	1.87	4.13	2.93	230
2-1/2"	2.37	3.05	1.91	4.41	3.06	200
3"	2.84	3.58	2.03	4.92	3.32	330
4"	3.84	4.69	2.39	6.18	4.00	470
6"	5.84	6.57	3.00	8.20	6.35	1,230
8"	7.93	8.54	3.28	11.22	7.83	1,300
10"	9.90	10.57	3.28	11.22	8.95	C/F
12"	11.90	12.56	2.87	13.46	9.09	C/F

Materials

No.	Part	Part
1	Body Half	316L Stainless Steel
2	Disc	316L Stainless Steel
3	Seal	Silicone/EPDM/Viton®
4	Body Bolts	304 Stainless Steel
5	Body Cap	Buna-N